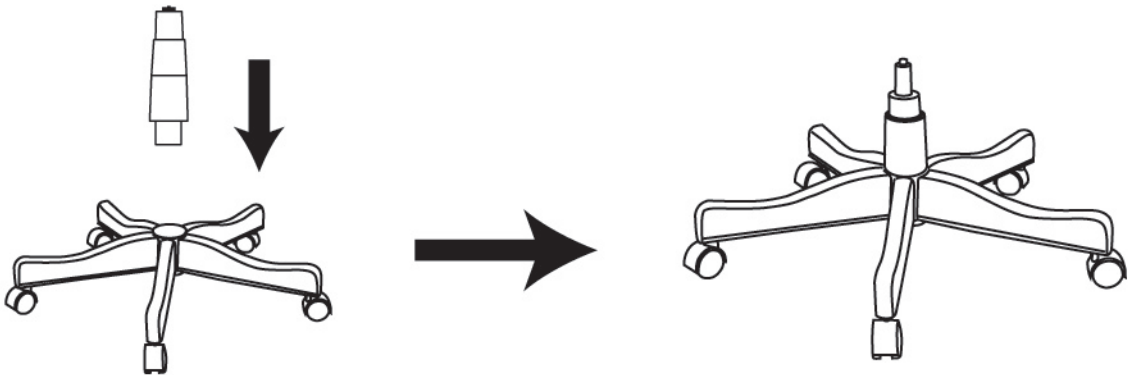

**Please unscrew all hardware from cushion before assembly.**

**Step 1**

**Insert the Gas Lift into the base**

**Step 2**

**Place the Chair onto the Base**

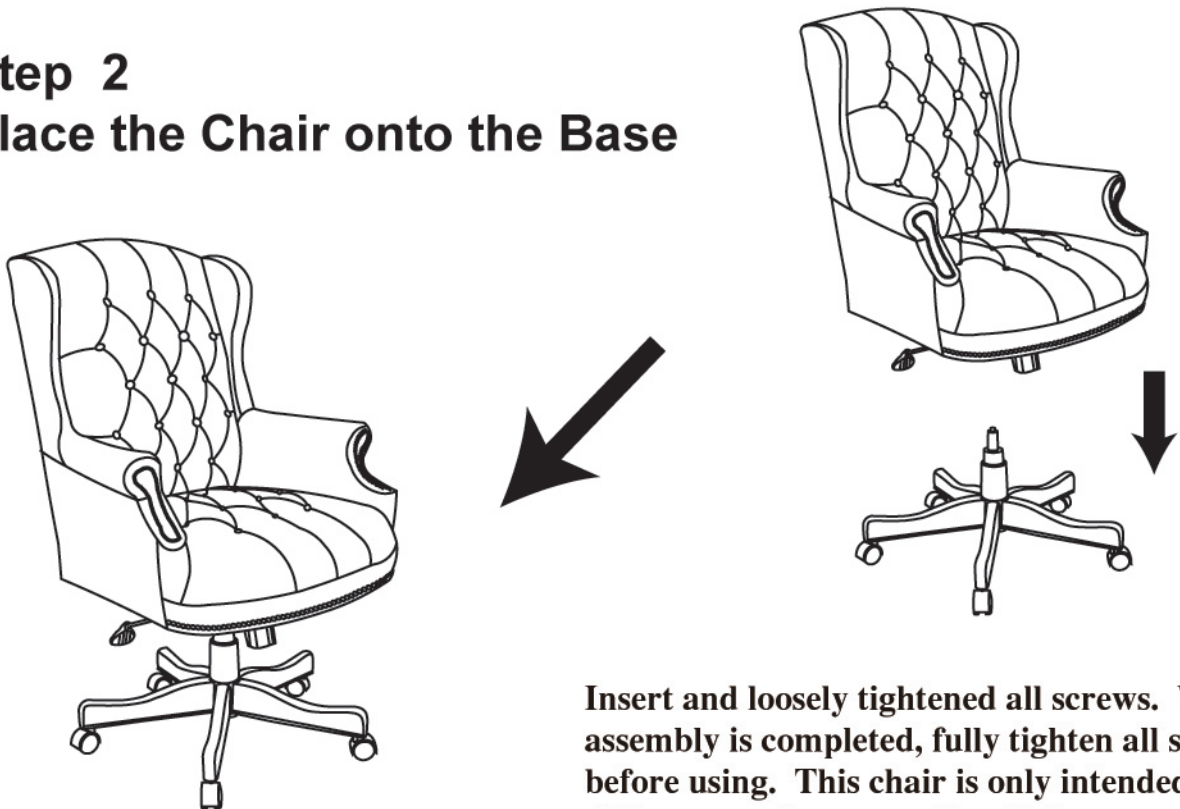

**Insert and loosely tightened all screws. When assembly is completed, fully tighten all screws before using. This chair is only intended for sitting, any other use will void the warranty.**

**Teknik Office Ltd, West One 63-67  
Bromham Road, Bedford, MK40 2FG  
TEL:01234 328804 FAX:01234 342446**

**If you encounter any problems with  
the operation of your chair, please  
refer to the downloads section of our  
web site - [www.teknikoffice.co.uk](http://www.teknikoffice.co.uk)**

