

The original **desktop**.

# Writing Desk

5418269

**NOTE:** THIS INSTRUCTION BOOKLET CONTAINS **IMPORTANT** SAFETY INFORMATION.

PLEASE READ AND KEEP FOR FUTURE REFERENCE.

# Table of Contents

# Assembly Tools Required

Part Identification	3
Hardware Identification	4
Assembly Steps	5-18
Français	19-21
Español	22-24
Safety	25-26
Warranty	27

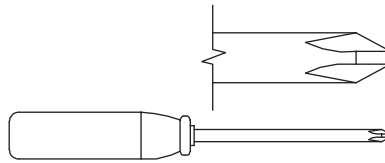

No. 2 Phillips Screwdriver  
Tip Shown Actual Size

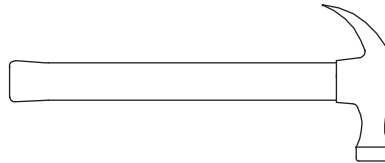

Hammer  
Not actual size 😊

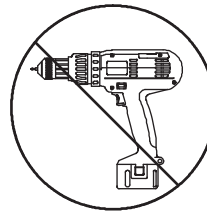

Skip the power trip.  
This time.

# Part Identification

Now you know  
our ABCs.



While not all parts are labeled, some of the parts will have a label or an inked letter on the edge to help distinguish similar parts from each other. Use this part identification to help identify similar parts.

A	RIGHT END (1)
B	LEFT END (1)
C	HUTCH RIGHT END (2)
D	UPRIGHT (1)
E	TOP (1)
F	HUTCH TOP (1)
G	MODESTY PANEL (1)
H	BACK (1)
I	RIGHT FRONT LEG (1)
J	LEFT FRONT LEG (1)
K	REAR LEG (2)
L	DRAWER FRONT (1)
M	HUTCH LEFT END (2)
D20	DRAWER RIGHT SIDE (1)
D21	DRAWER LEFT SIDE (1)
D74	DRAWER BACK (1)
D716	DRAWER BOTTOM (1)

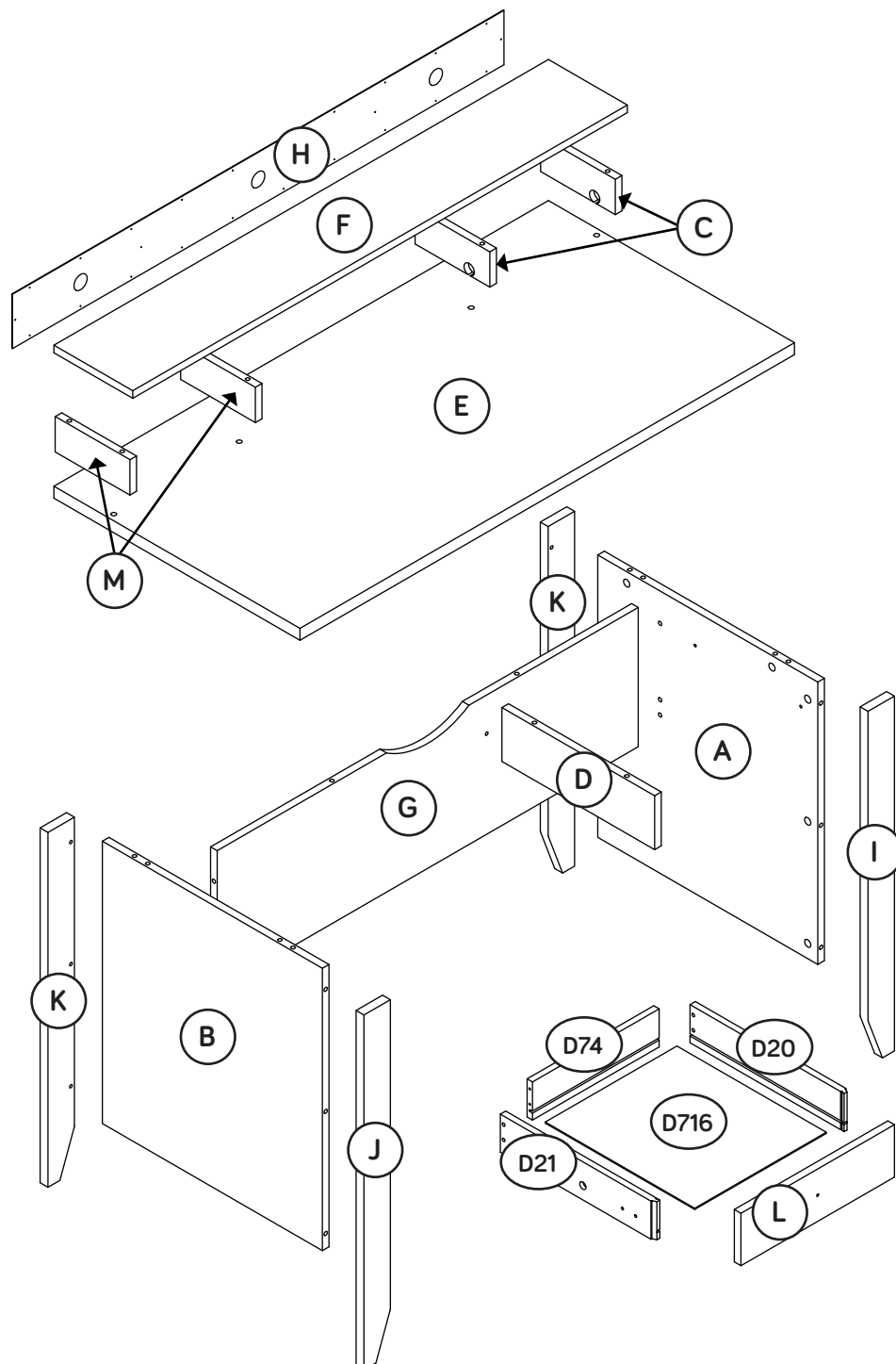

# Hardware Identification

↑ Screws are shown actual size. You may receive extra hardware with your unit.

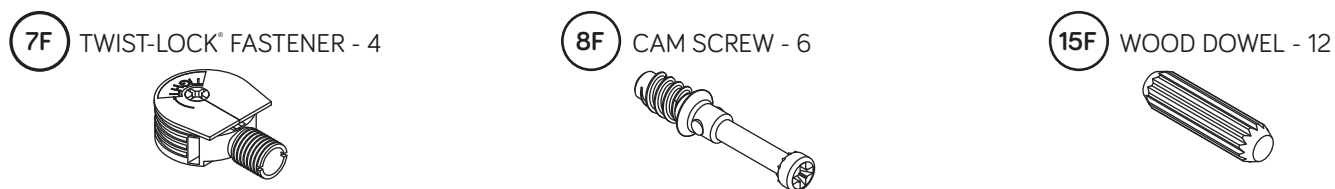
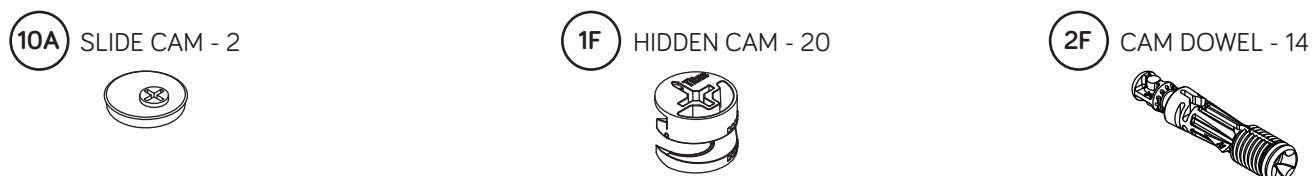
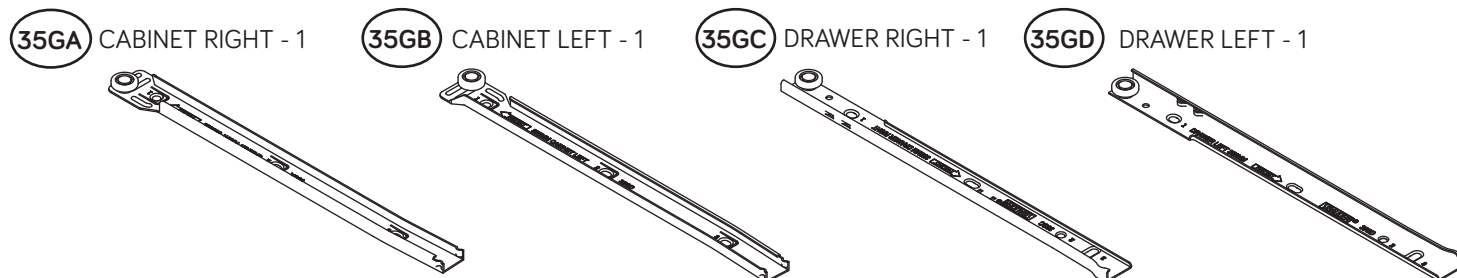

# Step 1

- ✚ Assemble your unit on a carpeted floor or on the empty carton to avoid scratching your unit or the floor.
- ✚ To begin assembly, push a SAUDER TWIST-LOCK® FASTENER (7F) into the large holes in the HUTCH ENDS (C and M).

Do not tighten the TWIST-LOCK® FASTENERS in this step.

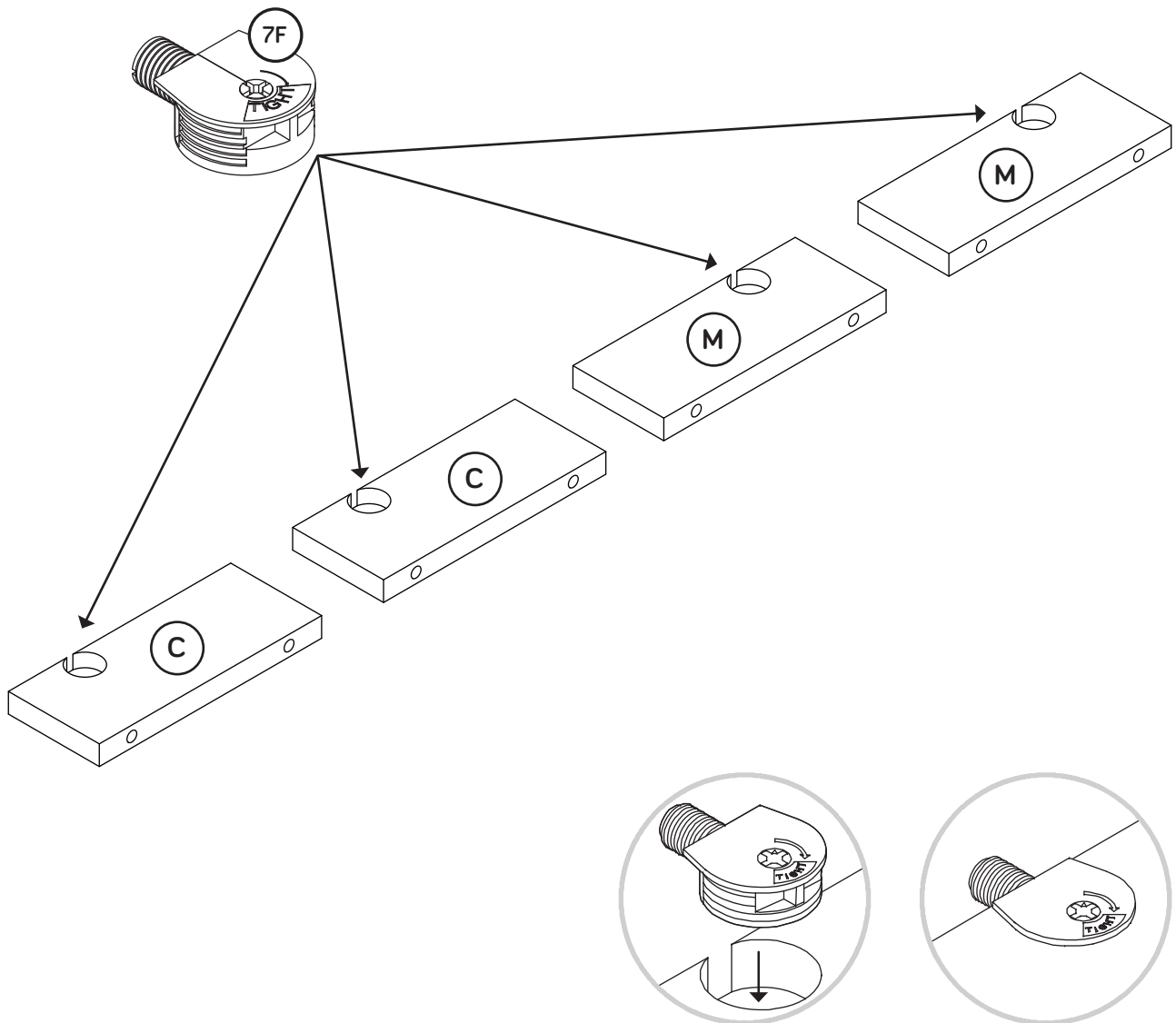

## Step 2

- ✚ Push twenty HIDDEN CAMS (1F) into the ENDS (A and B), UPRIGHT (D), and MODESTY PANEL (G). Then, insert the metal end of a CAM DOWEL (2F) into each HIDDEN CAM, except the long edges of the ENDS (A and B).

Do not tighten the HIDDEN CAMS in this step.

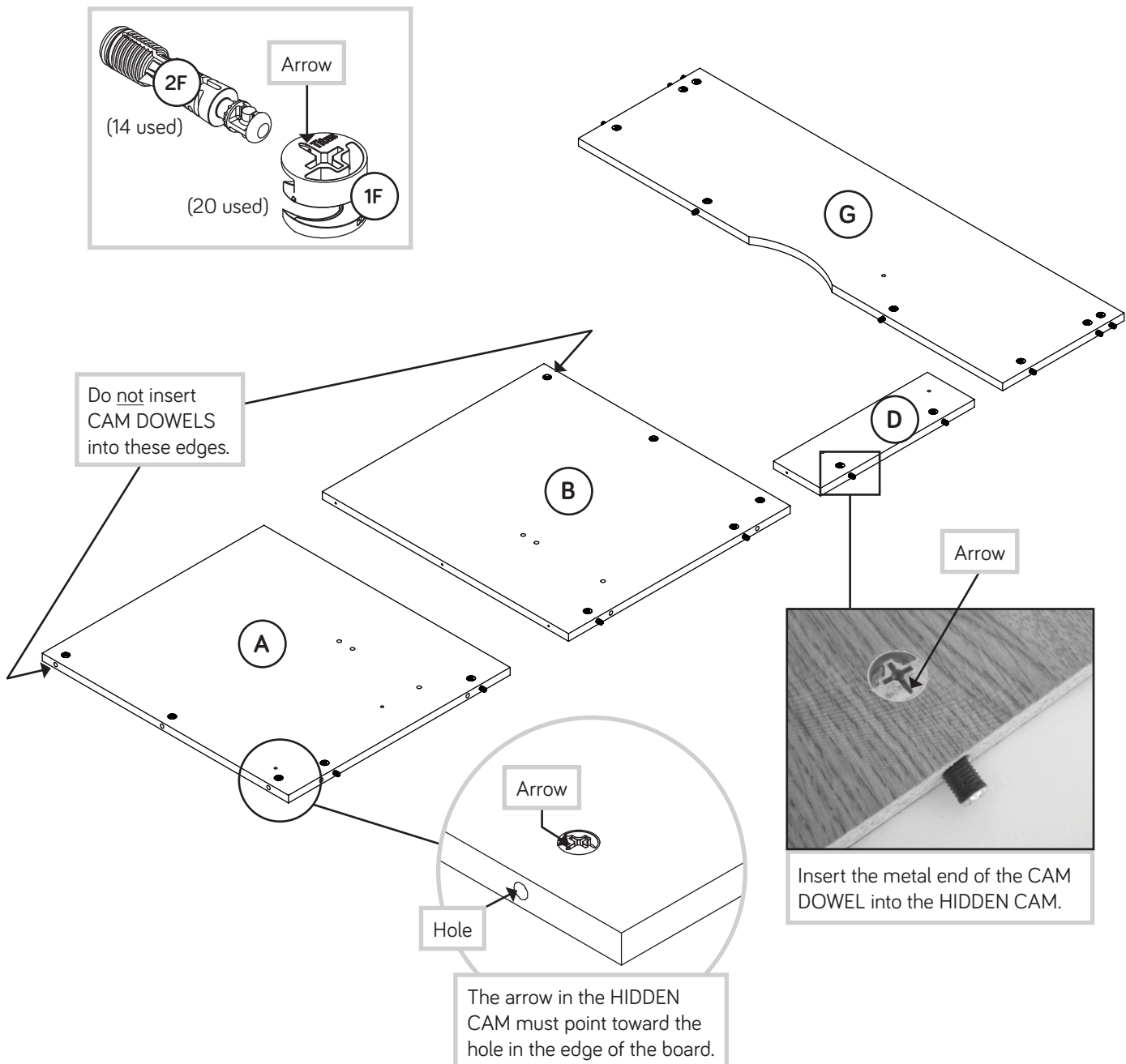

# Step 3

- Turn six CAM SCREWS (8F) into the FRONT LEGS (I and J).
- Fasten the ENDS (A and B) to the FRONT LEGS (I and J).  
Tighten six HIDDEN CAMS.

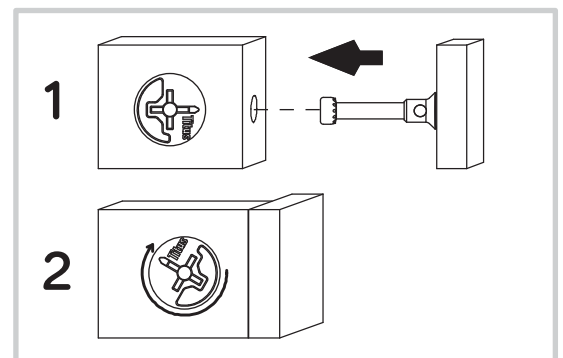
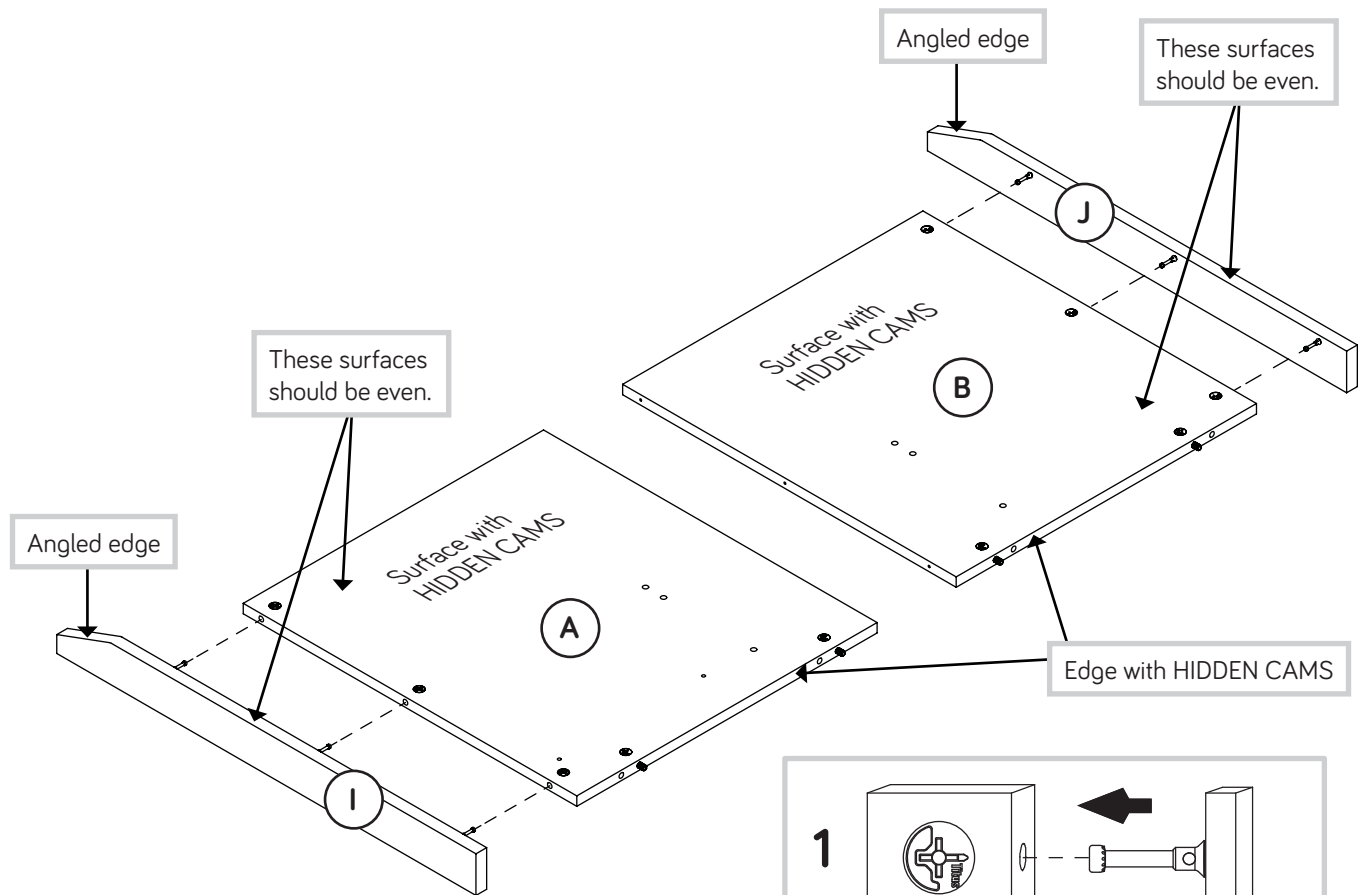
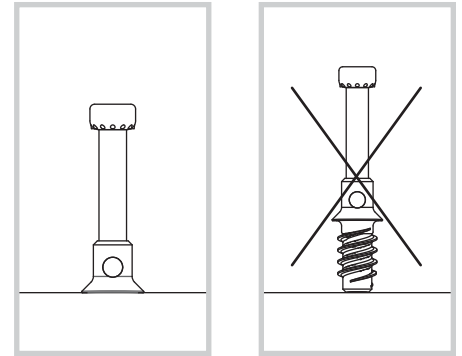
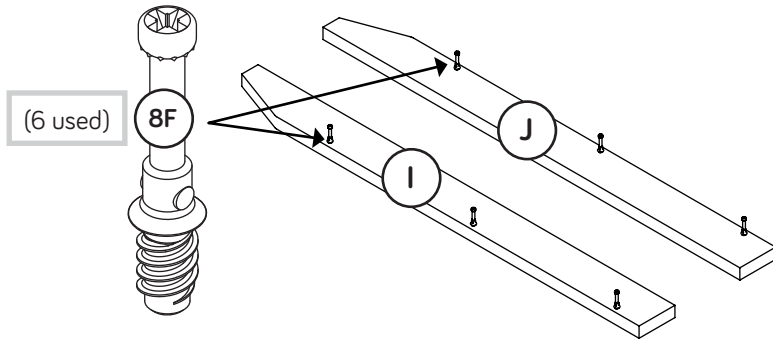

# Step 4

- ✚ Fasten the REAR LEGS (K) to the ENDS (A and B). Use six BLACK 1-7/8" FLAT HEAD SCREWS (2S).



Some assembly  
(and snacks) required.

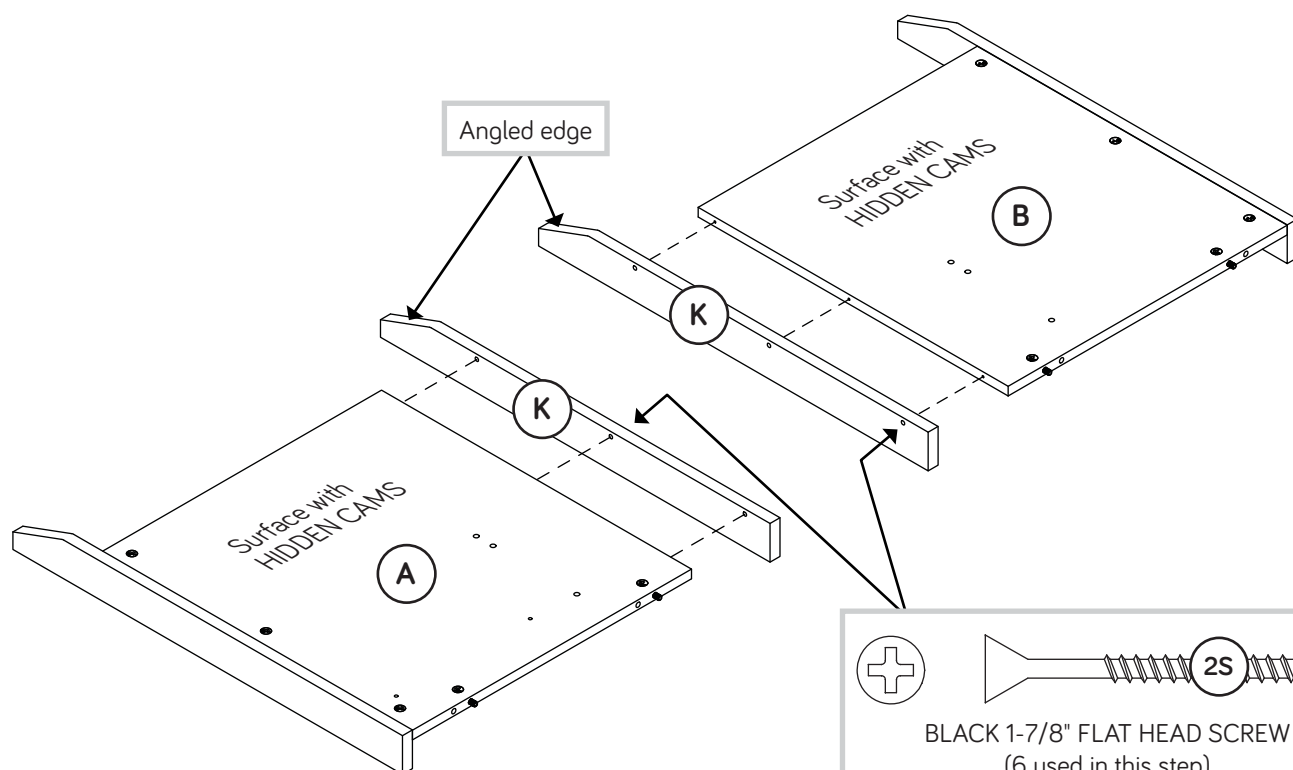



# Step 5

- ✚ Fasten the CABINET RIGHT (35GA) to the RIGHT END (A) and the CABINET LEFT (35GB) to the UPRIGHT (D). Use four GOLD 5/16" FLAT HEAD SCREWS (3S) through holes #1 and #3.



3S

GOLD 5/16" FLAT HEAD SCREW  
(4 used in this step)



Roller end

1

2

3

D

Edge and surface  
with HIDDEN CAMS

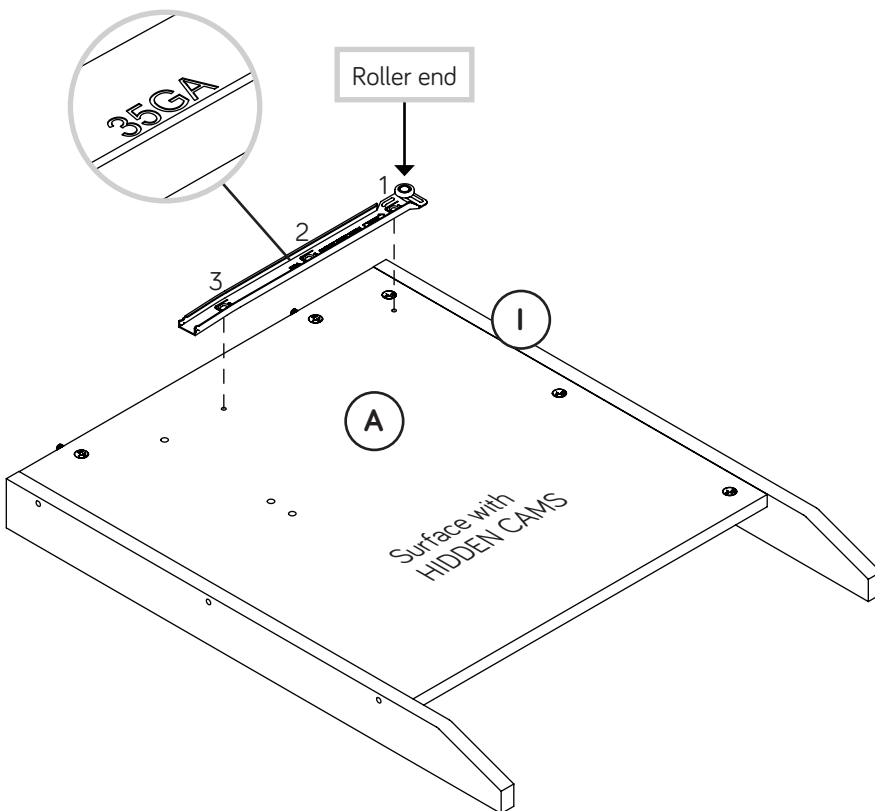

Roller end

1

2

3

A

Surface with  
HIDDEN CAMS

I

# Step 6

- Fasten the MODESTY PANEL (G) to the ENDS (A and B).
- Tighten six HIDDEN CAMS.

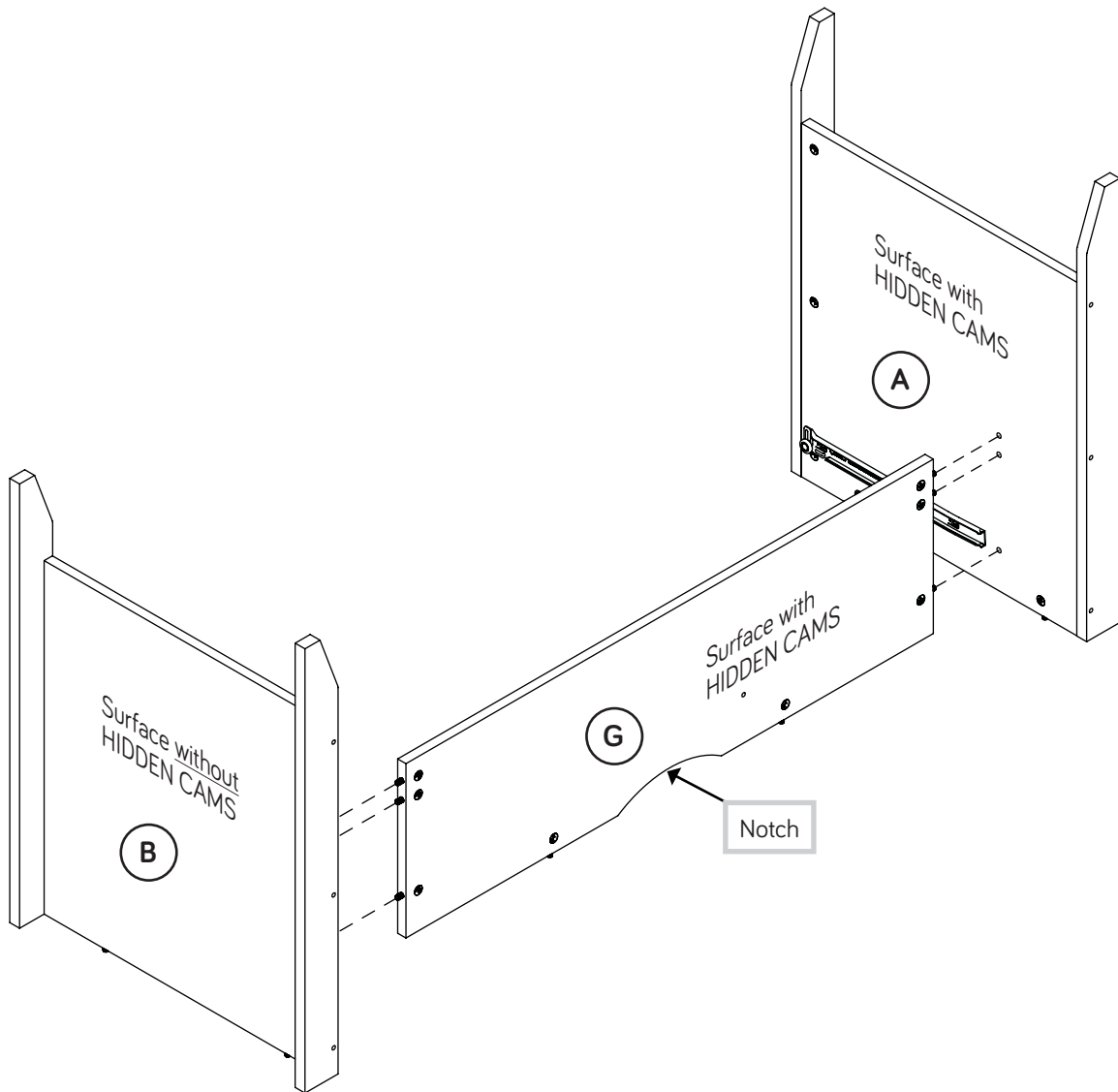

## ⚠ Caution

Risk of damage or injury. HIDDEN CAMS must be completely tightened. HIDDEN CAMS that are not completely tightened may loosen, and parts may separate. To completely tighten:

### Start

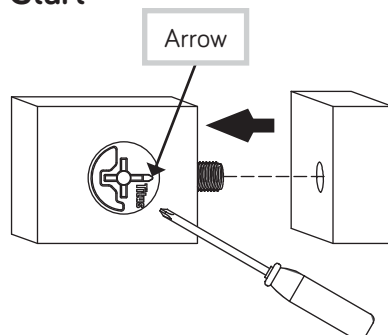

### Tighten

Maximum 210 degrees

Minimum 190 degrees

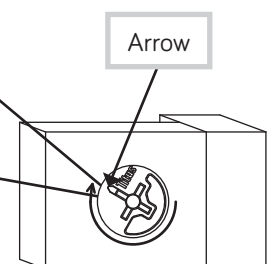

# Step 7

- ✚ First, fill four holes in the TOP (E) 1/4 to 1/2 full with GLUE (54M). Then, insert four WOOD DOWELS (15F) into the holes. Wipe away the excess GLUE.
- ✚ Next, place drops of GLUE (54M) onto the WOOD DOWELS (15F) in the TOP (E).
- ✚ Finally, fasten the TOP (E) to the ENDS (A and B) and MODESTY PANEL (G). Tighten six HIDDEN CAMS.
- ✚ NOTE: Be sure the WOOD DOWELS in the TOP insert into the holes in the ENDS. Wipe away the excess GLUE.

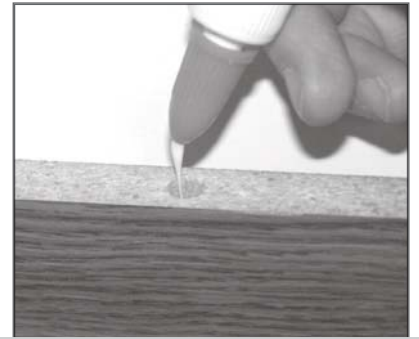

Fill the holes 1/4 to 1/2 full with GLUE.

## ⚠ Caution

Inspect the parts thoroughly before assembling. Disassembly of glued parts is extremely difficult.

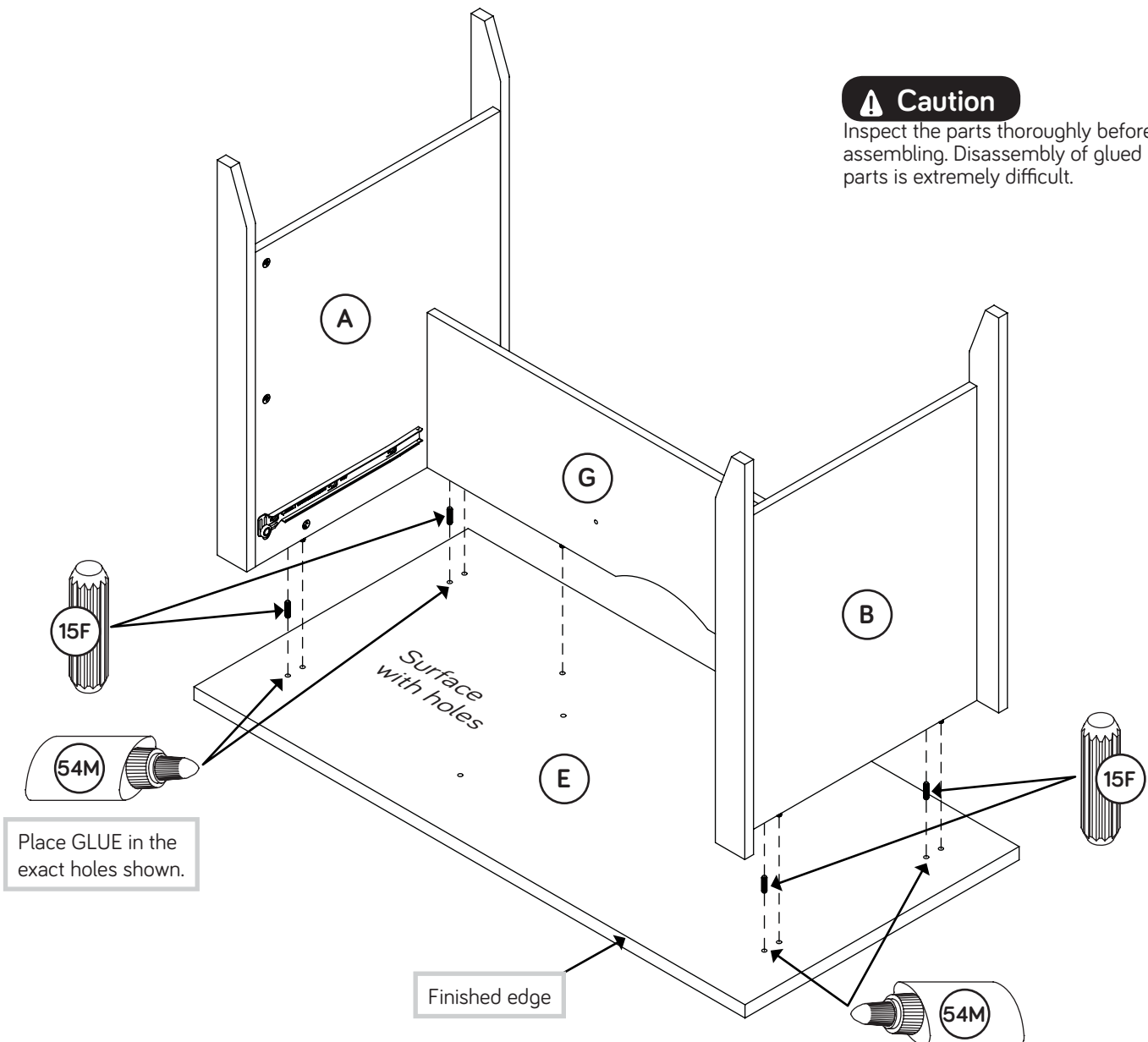

# Step 8

- Fasten the UPRIGHT (D) to the TOP (E). Tighten two HIDDEN CAMS.
- Fasten the UPRIGHT (D) to the MODESTY PANEL (G). Use one BLACK 1-7/8" FLAT HEAD SCREW (2S).

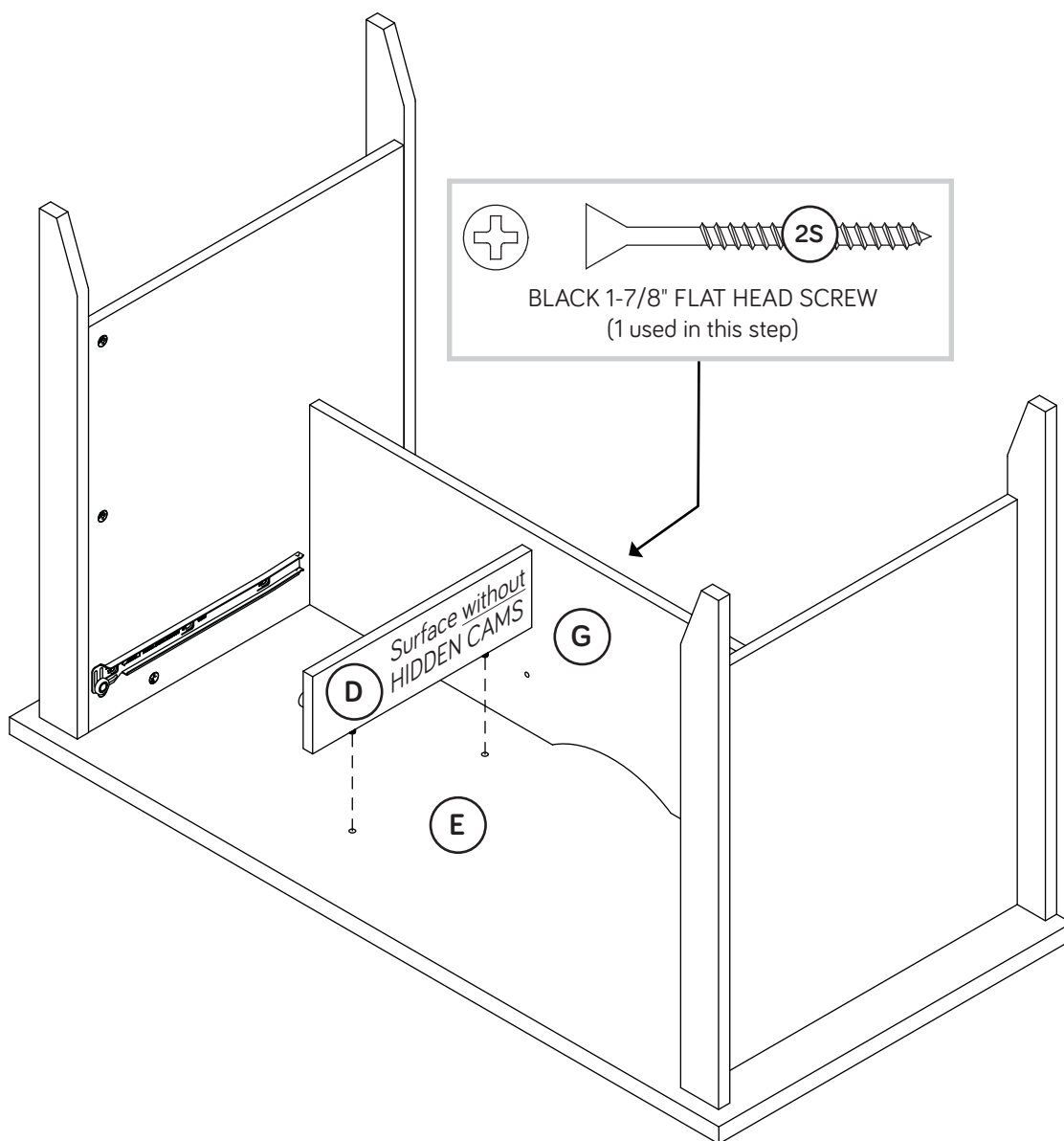
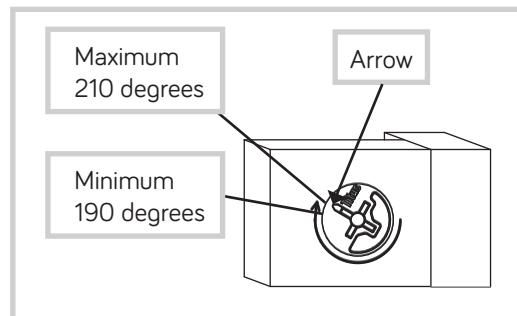

# Step 9

- ✚ Carefully stand your unit upright.
- ✚ Fasten the HUTCH UPRIGHTS (C and M) to the TOP (E). Tighten four TWIST-LOCK® FASTENERS.
- ✚ Fill the holes in the edges of the HUTCH UPRIGHTS (C and M) 1/4 to 1/2 full with GLUE (54M). Then, insert eight WOOD DOWELS (15F) into the holes. Wipe away the excess GLUE.
- ✚ Place drops of GLUE (54M) onto the WOOD DOWELS (15F) in the HUTCH UPRIGHTS (C and M).
- ✚ Press the HUTCH TOP (F) onto the WOOD DOWELS in the HUTCH UPRIGHTS. Wipe away the excess GLUE.

## How to use the SAUDER TWIST-LOCK® FASTENER

1. Insert the dowel end of the FASTENER into the hole of the adjoining part.

**NOTE:** The dowel end of the FASTENER must remain fully inserted in the hole of the adjoining part while locking the FASTENER.

2. Tighten the FASTENER with a Phillips screwdriver as tight as possible.

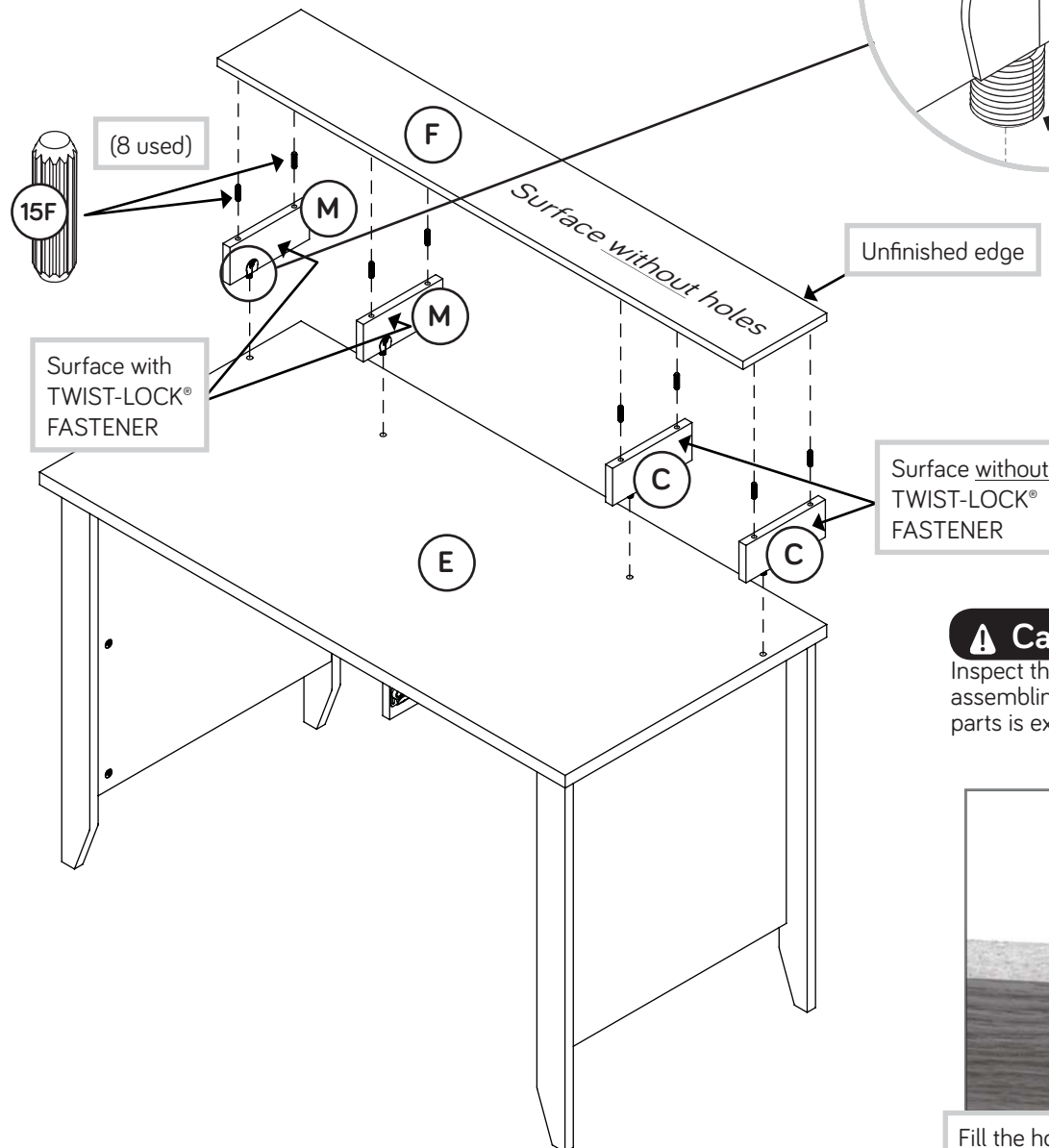
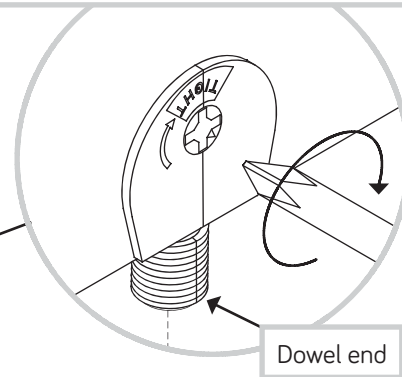

## ⚠ Caution

Inspect the parts thoroughly before assembling. Disassembly of glued parts is extremely difficult.

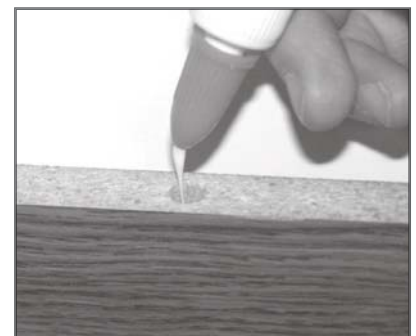

Fill the holes 1/4 to 1/2 full with GLUE.

# Step 10

✚ **IMPORTANT:** Do not pick up or move your unit by using the TOP (F).

✚ Fasten the BACK (H) to your unit using the NAILS (1N).

✚ **NOTE:** Be sure to tap NAILS into the holes that line up over the HUTCH UPRIGHTS (C and M).

✚ **NOTE:** Perforations have been provided for access through the BACK. Carefully cut out the holes needed.

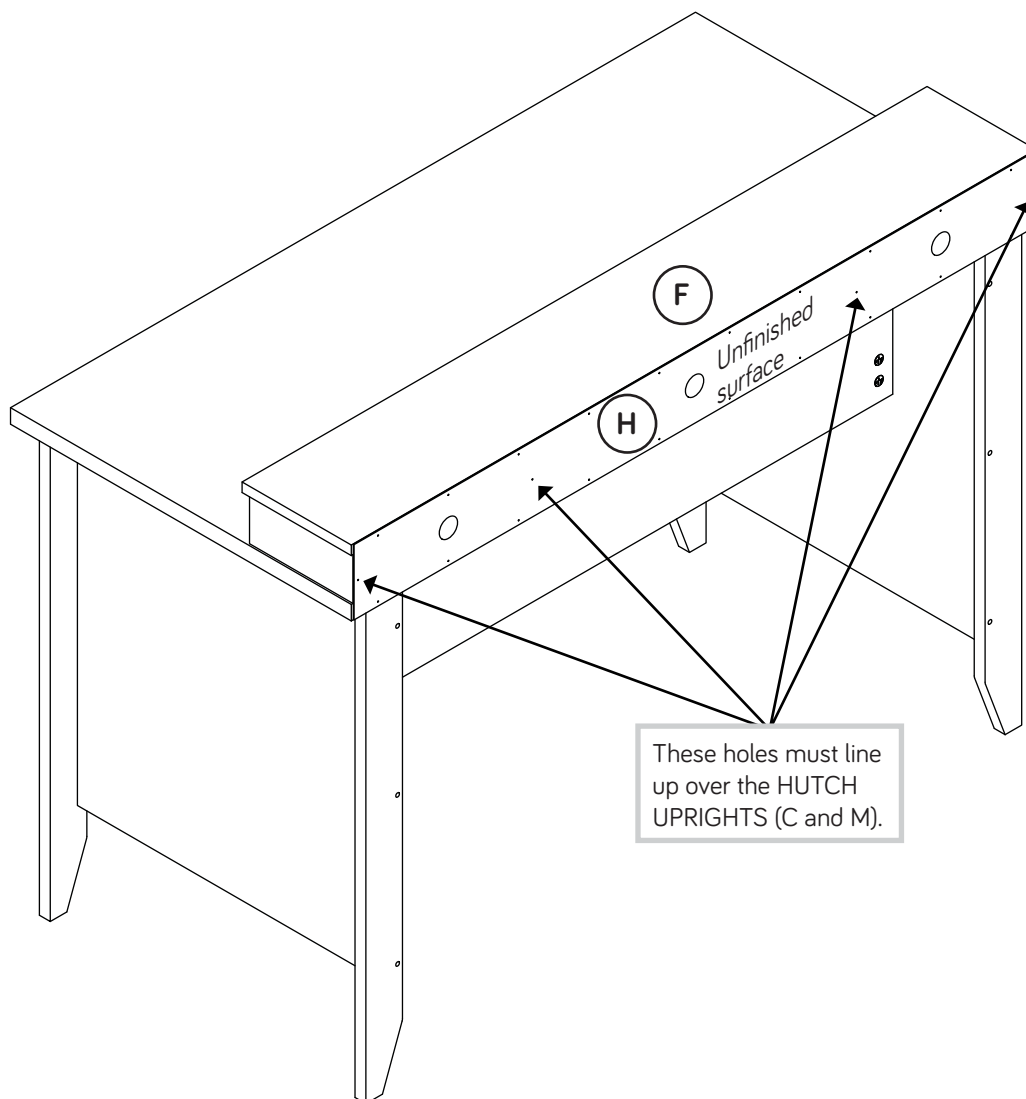

# Step 11

1

The tabs should insert freely into the slots. Gently tilt the DRAWER SIDES side to side until the tabs slip into the slots.

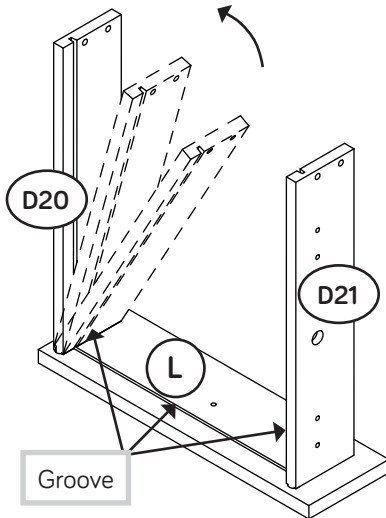

2

With the palm of your hand, tap the DRAWER BOTTOM down into the groove.

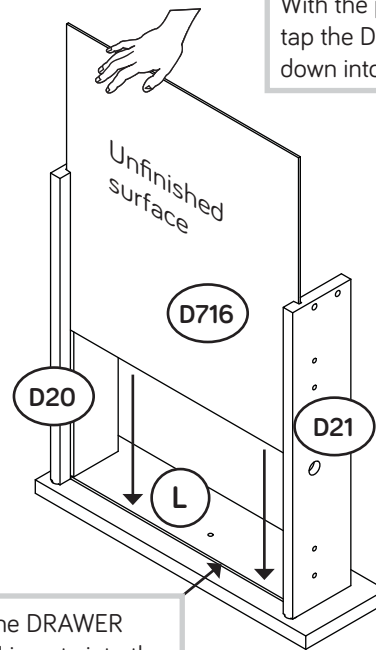

Be sure the DRAWER BOTTOM inserts into the DRAWER FRONT groove.

✚ Insert the DRAWER SIDES (D20 and D21) at an angle into the slot at each end of the DRAWER FRONT (L).

✚ Slide the DRAWER BOTTOM (D716) into the grooves in the DRAWER SIDES (D20 and D21) and DRAWER FRONT (L).

3

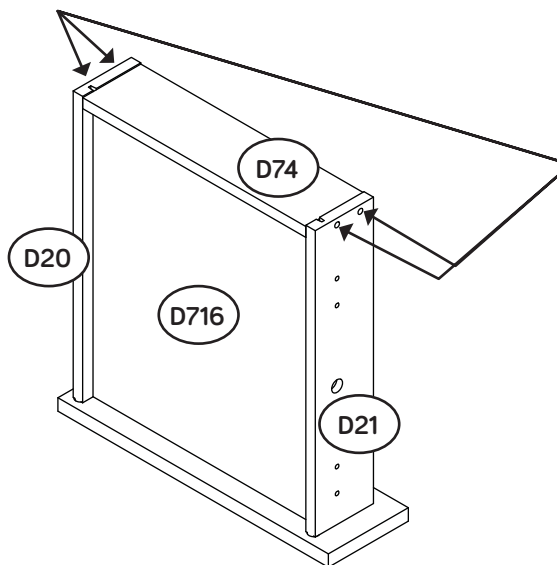

Start each screw a few turns before completely tightening any of them.

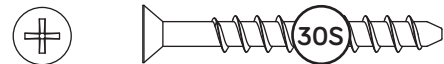

BLACK 1-9/16" FLAT HEAD SCREW  
(4 used in this step)

✚ Fasten the DRAWER BACK (D74) to the DRAWER SIDES (D20 and D21). Use four BLACK 1-9/16" FLAT HEAD SCREWS (30S).

✚ NOTE: Be sure the DRAWER BOTTOM (D716) inserts into the groove of the DRAWER BACK (D74).

# Step 12

- ✚ Insert a SLIDE CAM (10A) into the DRAWER SIDES (D20 and D21).
- ✚ Fasten the DRAWER RIGHT (35GC) to the DRAWER RIGHT SIDE (D20) and the DRAWER LEFT (35GD) to the DRAWER LEFT SIDE (D21). Use four GOLD 5/16" FLAT HEAD SCREWS (3S) through holes #1 and #3.
- ✚ NOTE: The screw head in the CAM must be visible through the slotted hole in the SLIDE.
- ✚ Fasten the KNOB (25K) to the DRAWER FRONT (L). Use a BLACK 7/8" MACHINE SCREW (37S).

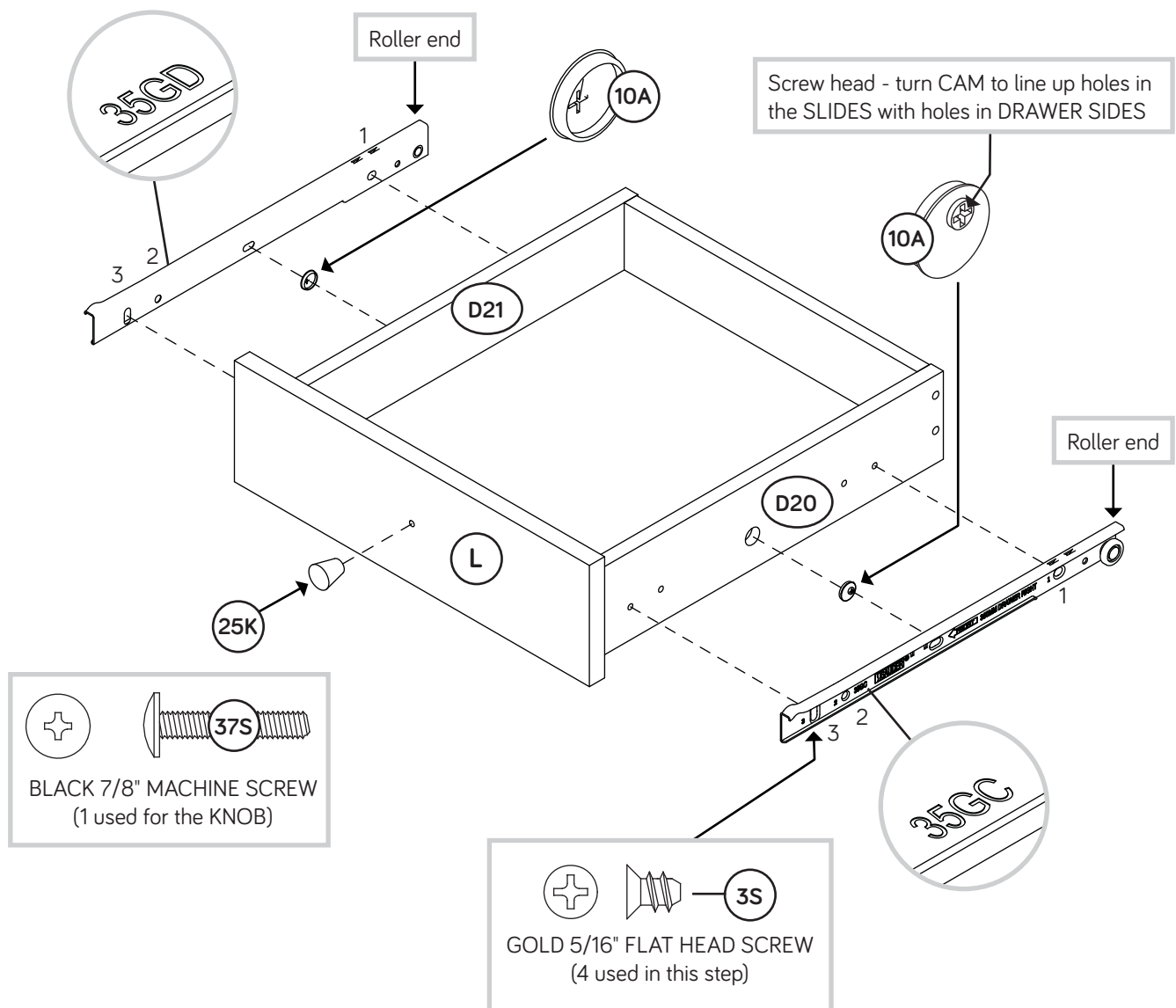



# Step 13

- ✚ To insert the drawer into your unit, tip the front of the drawer down and drop the rollers on the drawer behind the rollers on the unit. Lift the front of the drawer up and slide it into the unit.
- ✚ Push a CAM COVER (12P) onto each visible HIDDEN CAM.

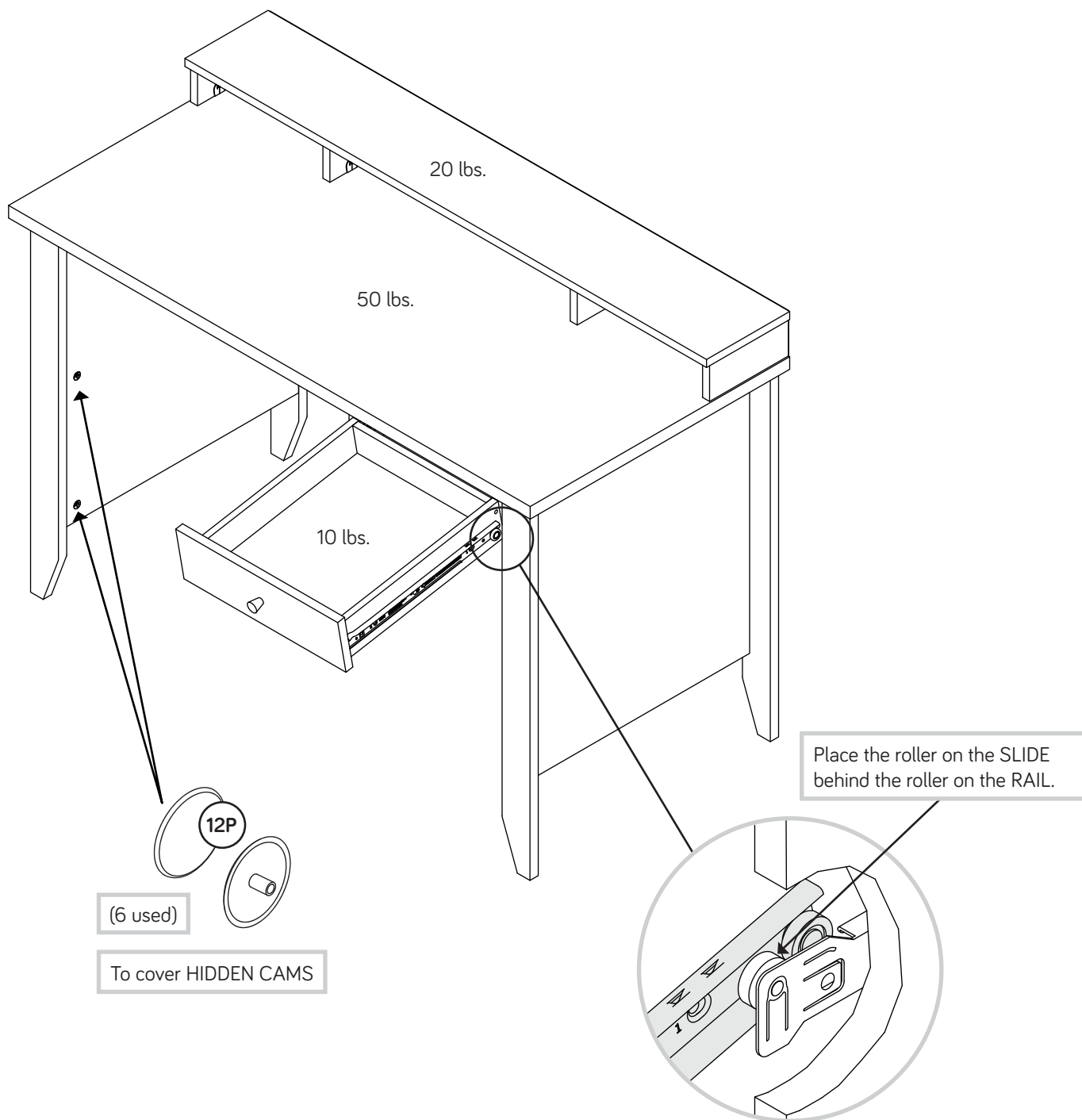

# Step 14

- ✚ To make adjustments to the drawers, loosen SCREW #3 in the SLIDES a 1/4 turn, then turn the CAM clockwise or counter-clockwise. Notice how the drawer raises or lowers as you turn the CAM. The higher the screw in the oblong hole, the higher your drawer front will be. The lower the screw, the lower the drawer front. By adjusting the drawers this way, it will help the DRAWER FRONTS line up better when closed. Tighten the SCREW when finished with adjustments.
- ✚ NOTE: Please read the back pages of the instruction booklet for important safety information.
- ✚ This completes assembly. Clean with your favorite furniture polish or a damp cloth. Wipe dry.

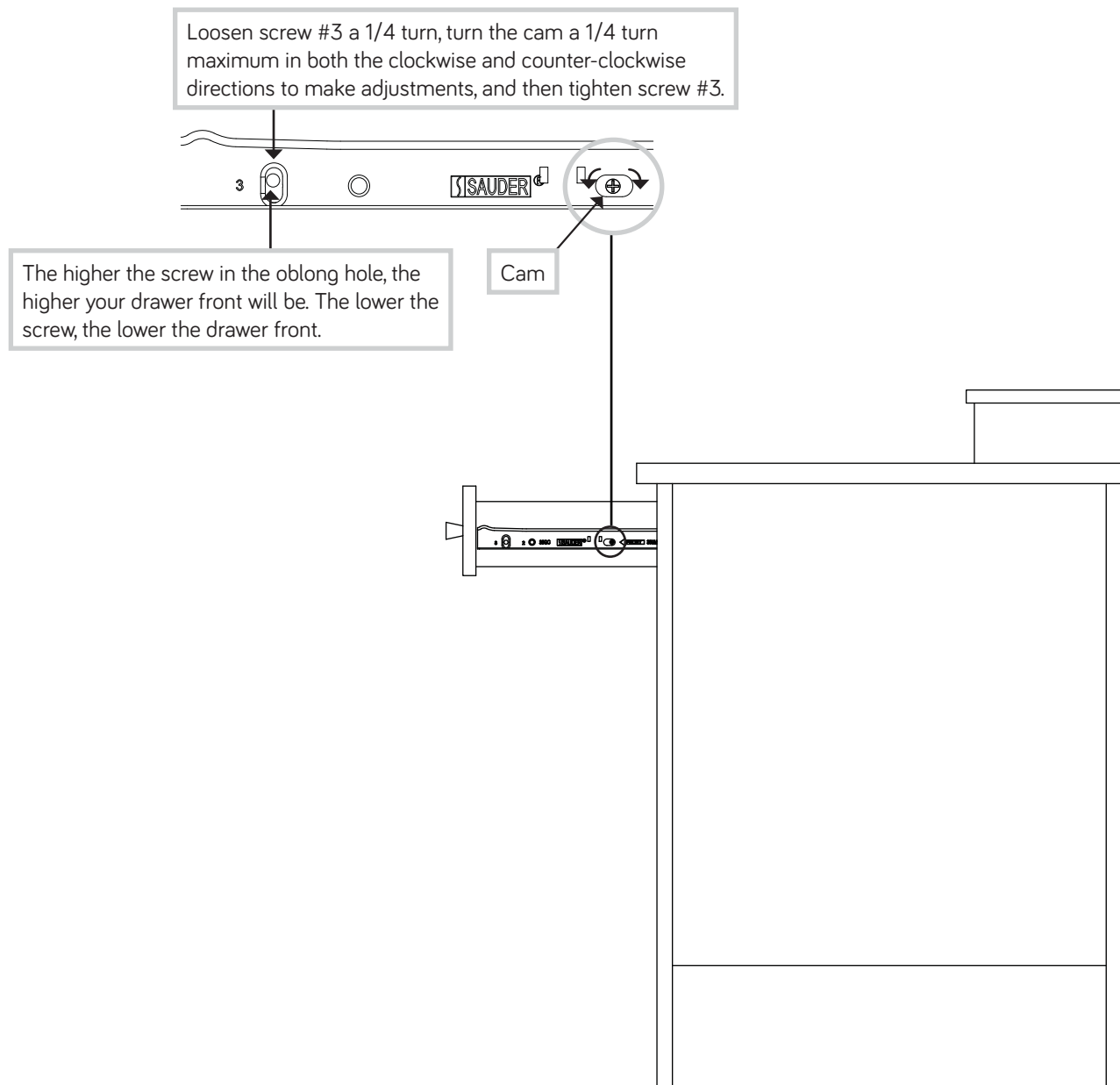

## WARNING

Please use your furniture correctly and safely. Improper use can cause safety hazards, or damage to your furniture or household items. ***Carefully read the following chart.***

Look out for:	What can happen:	How to avoid the problem:
<ul style="list-style-type: none"><li>• Overloaded shelves and drawers.</li><li>• Improper loading can cause the product to be top-heavy.</li></ul>	<ul style="list-style-type: none"><li>• Risk of injury.</li><li>• Top-heavy furniture can tip over.</li><li>• Overloaded shelves and drawers can break.</li></ul>	<ul style="list-style-type: none"><li>• Never exceed the weight limits shown in the instructions.</li><li>• Work from bottom to top when loading shelves and drawers. Place the heavier items on the lower shelves or in lower drawers.</li></ul>
<ul style="list-style-type: none"><li>• Improperly moving furniture that is not designed and equipped with casters.</li></ul>	<ul style="list-style-type: none"><li>• Furniture can tip over or break if improperly moved.</li><li>• Physical injury. Furniture can be very heavy.</li><li>• Breakage of tops - particularly with double pedestal furniture (drawers at both ends).</li></ul>	<ul style="list-style-type: none"><li>• Unload shelves and drawers from top to bottom before moving the unit.</li><li>• Do not push furniture, especially on a carpeted floor. Have a friend help you lift the item and set it in place.</li><li>• Provide support to the center section of the top when lifting the furniture.</li></ul>
<ul style="list-style-type: none"><li>• Placing TVs on furniture items that are not designed to support a television is hazardous.</li></ul>	<ul style="list-style-type: none"><li>• Risk of injury or death. TVs can be very heavy. Plus the weight and location of the picture tube tends to make TVs unbalanced and prone to tipping forward.</li></ul>	<ul style="list-style-type: none"><li>• This product is not designed to support a television.</li></ul>